

# RGB RECHARGEABLE MAGNETIC LIGHT

Product Instructions | Part No: 98001

## APPLICATION

See [kolpin.com](http://kolpin.com) for instructions, warnings and fitment.

## KIT CONTENTS

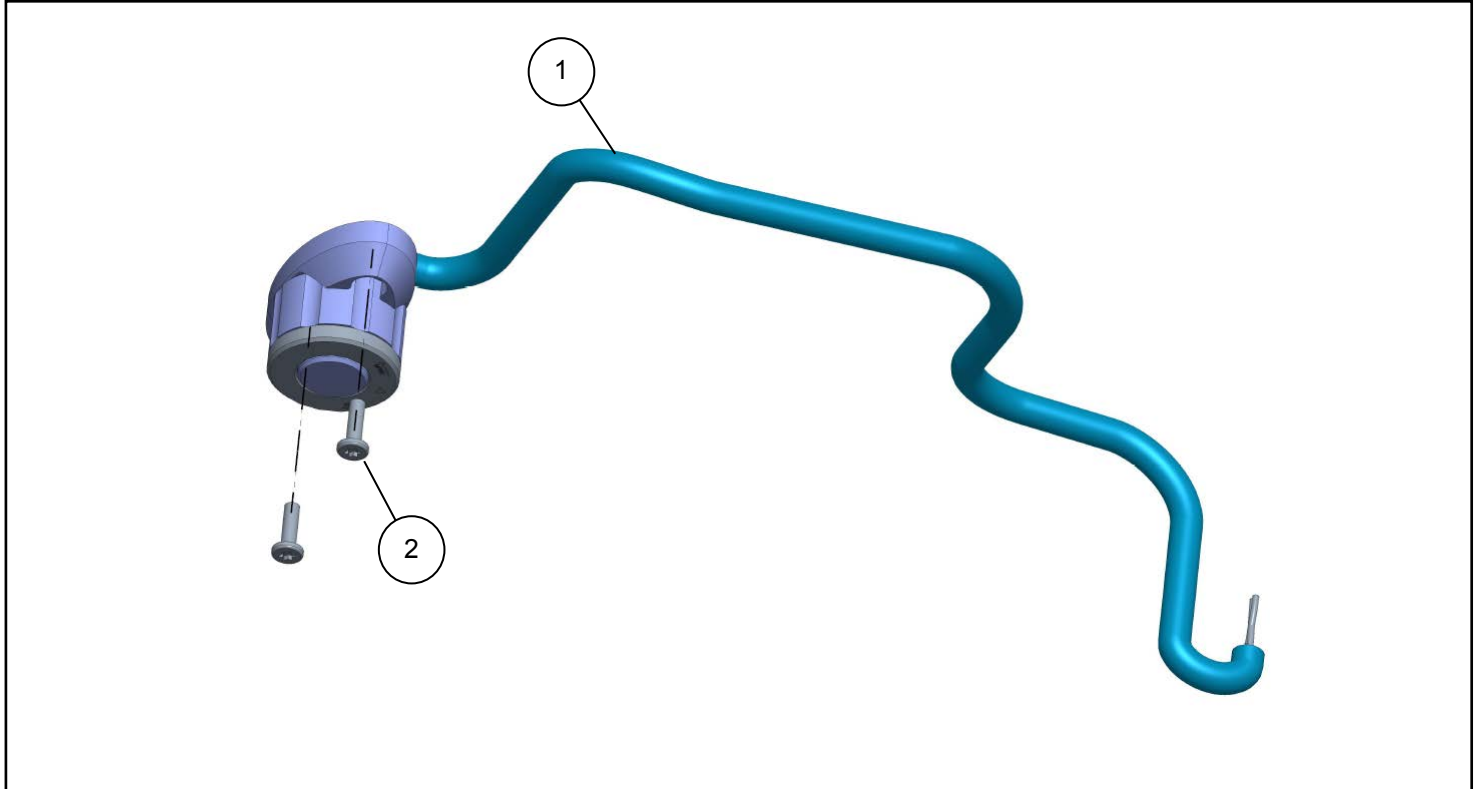

REF	QTY	PART DESCRIPTION	REPLACEMENT P/N
1	1	Light, Overhead, RGB Removable (with harness)	N/A
2	1	Screw, Torx® Pan Head, High/Low #10 x 5/8	N/A
3	2	M8 Ring Terminals (Not Shown)	N/A
4	1	Instructions	N/A

## TOOLS REQUIRED

- Wire Crimpers
- Wire Cutters
- Screwdriver set, Torx®

## ASSEMBLY TIME

Approximately 20 minutes

## BEFORE YOU BEGIN

- See [www.kolpin.com](http://www.kolpin.com) for instructions, warnings, and fitment.
- Please read the installation instructions thoroughly before beginning. Installation is easier if the vehicle is clean and free of debris. For your safety, and to ensure a satisfactory installation, perform all installation steps correctly in the sequence shown.
- Verify all parts and tools are accounted for. If parts are missing, do not return to the store. Call us for help, **Toll Free 1-877-956-5746**

## INSTALLATION INSTRUCTIONS

1. Shift vehicle transmission into "PARK". Turn key to "OFF" position and remove from vehicle.
2. Determine the mounting location for the RGB Dome Light on your vehicle, typically mounted to the roof. Considerations for selecting the mounting location:
  - Where you want the light projecting when mounted
  - Wire routing to your vehicle electrical connections
  - Access to the light for turning on / off when installed
  - Ease of removal for use as a removable light
3. Install the light (Item 1) using the provided screws (Item 2). Do not over-tighten screws.
4. Route electrical wires to electrical connection.

### NOTICE

RGB Dome Light will draw power from your vehicle for charging the RGB battery when the light is mounted in its base. Consider connecting to a keyed accessory circuit to avoid powering the Dome light when not using the vehicle.

## ONE YEAR LIMITED WARRANTY

For the period of one (1) year from the purchase date, Kolpin will replace for the original purchaser, free of charge, any part or parts found upon examination by Kolpin to be defective in material, workmanship, or both.

All transportation costs incurred submitting product to Kolpin for warranty consideration must be borne by the purchaser. If Kolpin determines that the product must be returned to the factory for credit, please call 1-877-956-5746 for a Return Merchandise Authorization (RMA) number and shipping instructions.

This warranty does not apply to parts that have been damaged by accident, alteration, abuse, improper maintenance, normal wear, or other causes beyond the manufacturer's control. In order to protect you and your ATV, certain parts of the accessory system and/or hardware are designed to fail when the equipment is over-stressed. Parts that are lost due to loosening and improper maintenance are not covered under warranty. This warranty does not cover removal or reinstallation labor fees of the accessory system and related components. Most hardware is general in nature and is easily obtained locally. Be sure to replace with minimum metric class 8.8 specification.

**Kolpin Outdoors, Inc.**

**Telephone: (763)-478-5800**

**Toll Free: (877)-956-5746**

**Fax Number: (800)-245-7569**

**[www.kolpin.com](http://www.kolpin.com)**

**Email: [customerservice@kolpin.com](mailto:customerservice@kolpin.com)**